

REV	DATE	REVISION DETAILS	APPD
A	July 8, 2013	Part No changed from 6NW to 4NW	Zhangjian

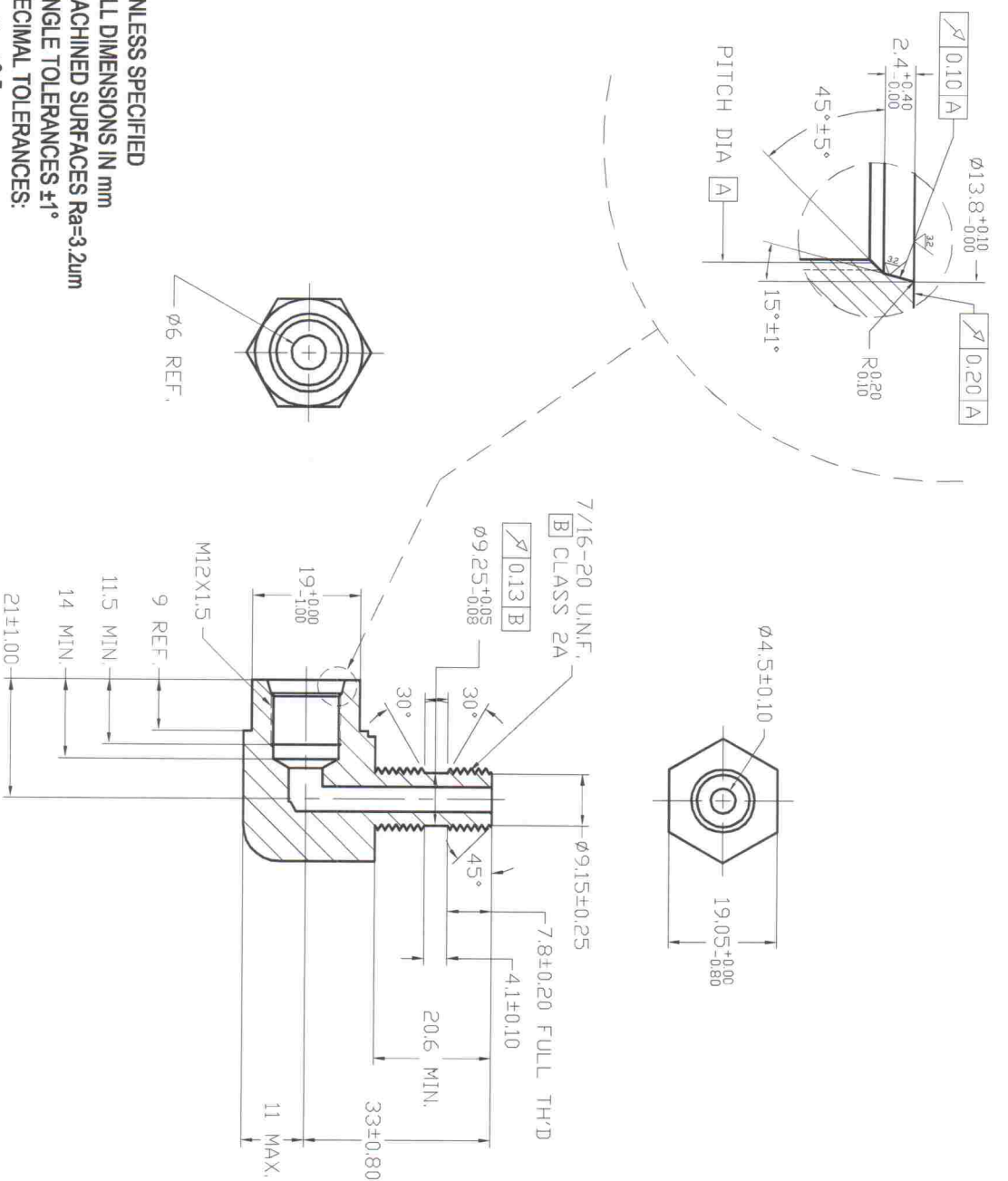

螺母

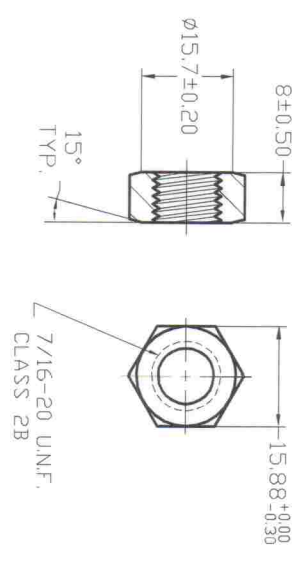

垫片

UNLESS SPECIFIED  
ALL DIMENSIONS IN mm  
MACHINED SURFACES Ra=3.2um  
ANGLE TOLERANCES ±1°  
DECIMAL TOLERANCES:  
.x: ±0.5  
.xx: ±0.25  
.xxx: ±0.127

MATERIAL	Chinese steel 45	PART No	40910-M12PT-4NW		
FINISH	Remove all sharp edges, burrs, slivers and swarf, break all edges 0.127-0.254mm ZINC PLATED WITH TRIVALENT CHROMATE AND NO RPD CORROSION IN 96 HOURS SALT SPRAY TEST.	SCALE:	APPD:	DRN:	
		NTS	L. G. Pan	L. G. Pan	
			DATE:	CHK:	
			2012. 12. 24	L. G. Pan	

去除所有毛刺, 铁屑等残留物, 破边倒钝0.127-0.254mm.  
镀三价铬, 银白色, 96小时盐雾试验无红锈。